

# “Teaching Small Children & Their Families to Glorify God”



## Messiah's Children Preschool

Messiah Lutheran Church  
Jenny Wockenfuss, Teacher  
Danielle Tews, Teacher  
Pastor Justin Gran  
Danee Haro, Director

534 W. Iowa Avenue, Nampa, ID 83686  
(208) 465-4511

MessiahNampa.com

E-mail—[mcpreschool@messiahnampa.com](mailto:mcpreschool@messiahnampa.com)

### Sunday Morning Schedule

Worship Service (traditional)	8:30 am
Sunday School (age 2-7th grade)	9:30 am
Bible Classes (adult and teen)	9:30 am
Kids Church (age 3-5th grade)	10:30 am
Worship Service (informal)	10:30 am

All services are online at [MessiahNampa.com](http://MessiahNampa.com)

### Messiah's Kids Church

10:30-11:30 am every Sunday-For ages 3-5th grade

Your kids will enjoy an age appropriate service while you worship with the adults.

Check your child in with Mrs. W. in the Kids Church building.

They will join you at the end of the service.

### Statement of Belief

This school is an extension of Messiah Lutheran Church. We are a congregation of the Wisconsin Evangelical Lutheran Synod (WELS). As a congregation, we are striving to be a family where the Triune God is glorified by all, to all, with our all.

We do not claim to be the only saving church, but we do endeavor to preserve and to pass on the truth as it is found in the Bible. Therefore, among other things, we believe, teach, and confess that:

- The Bible is the inerrant, inspired Word of God.
- There is only one God. He is three distinct and separate persons: Father, Son and Holy Spirit. (1 Corinthians 8:4, Matthew 28:19)
- We have failed to do what God requires. We are sinners who deserve to be punished. (Romans 3:10-11)
- God in His mercy sent His Son, Jesus Christ, to save us - not by telling us what to do - but by doing it for us. (Galatians 2:16, 2 Corinthians 5:21)
- Jesus delivered us from sin, death and the power of the devil. (1 John 2:2)
- This wonderful fact is ours through faith in Jesus, which is worked in our hearts by the Holy Spirit through the gospel in the Word and Sacrament. (Romans 10:17, 1 Peter 3:21, Matthew 26:28)
- Through this faith in Jesus, we are heirs of the glories of heaven. While yet here on earth, we want to show our love to him who first loved us. (Titus 2:14)

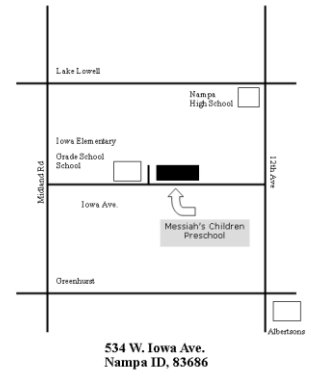

534 W. Iowa Ave.  
Nampa ID. 83686



## Our Purpose

Our purpose is to teach children about the wonderful blessing of being God's children through faith in Jesus Christ. This will be accomplished by using God's law to show children their need for a Savior, and God's gospel to show children that Jesus is their Savior.

Parents play a vital role in accomplishing this purpose. Therefore, we will also offer parents encouragement, opportunities, and help in fulfilling their roles as parents.

Our entire Messiah Church family cares about those who attend our preschool. Our goal is that the pastor, director, teaching staff, parents, students and congregation work together for a single goal of Christ-centered excellence in early childhood education. Our pastor is involved in leading Preschool Church, interacts with parents and students regularly, and is ready and willing to offer spiritual guidance and counsel to any of our school families. It is strongly encouraged that parents take advantage of any instruction classes that are provided, so that you are familiar with the instruction in God's Word your child will receive. Those opportunities will be announced regularly.

## Nondiscriminatory Policy

Messiah's Children Preschool admits students of any race, color, national and ethnic origin to all the rights, privileges, programs, and activities generally accorded or made available to students at the school. It does not discriminate on the basis of race, color, national and ethnic origin in administration of its educational policies, admissions policies, and other school-administered programs.

## Is Your Child Ready For Preschool?

THEY MUST BE ABLE TO:

- work and play with other students of same age.
- use the bathroom by themselves and are daytime toilet trained.
  - handle their own clothing and wash their own hands.
- sit for short periods of time and attend to a task.
- participate in discussions: one-on-one, small groups, and a large group.
- listen to and follow simple directions.

## Registration Requirements

Registration requirements are as follows:

- the child is three or four years old before September 1st of the enrollment year for appropriate class
- you verify your child is ready for preschool as described previously
- the completion of all forms
- copies of immunization record and birth certificate accompany the application
- non-refundable application fee paid.

## Curriculum

(Graduated curriculum based on State Kindergarten Standards)

Please note: The 3 year old class curriculum is marked with an \*.

Our curriculum provides the child with age appropriate activities and experiences in the following areas:

Daily Bible Stories*	Math	Fine and Gross Motor Skills*	Community Awareness
Basic Classroom Skills*	Science	Indoor and Outdoor Play*	Music and Movement*
Language Arts	Creative Play	Memorization*	Arts and Crafts*
Social Development*	Basic Kindergarten Readiness		

## School Year and Closings

- Our school year runs from Labor Day through the end of May with school vacations running in accordance with the *Nampa School District*. **The preschool will remain open on Nampa School “In Service” days.** A school year calendar will be provided.
- We observe the following holidays, therefore there will be No school on:  
Thanksgiving                      Christmas Break  
Idaho Human Rights Day        President’s Day                  Spring Break
- In cases of bad weather, we will follow Nampa School District for closing. This closure will not be made up if only one class period is canceled. In the event of additional closures, a make-up class will be considered on an “as needed” basis.
- In the event of an emergency closing, parents will be contacted via the “Remind” App.

## Attendance and Illness

- Notify the teacher when your child will be absent. Please use the preschool phone number 208-465-4511, or contact your child’s teacher via “Remind”. Please leave a message on the machine if there is no answer.
- **PLEASE, DO NOT BRING A SICK CHILD TO SCHOOL!** If there is any doubt, it is best to keep your child home. If you have questions regarding an illness, please call the school **prior** to bringing your child to class.
- If your child has had a fever, diarrhea, or vomited within 24 hours prior to the session, **DO NOT BRING YOUR CHILD TO SCHOOL.** You will be called to pick up your child if he/she becomes sick at school.
- All contagious illnesses (covid, chicken pox, etc.) or situations (head lice, etc.) *-or exposure to-* should be reported to the teacher so other parents can be informed. In such cases, a child’s identity will be held in strict confidence.
- Parents should report to the teacher or the Preschool if an extended absence occurs. This allows the school to know the intent of the parents to keep the child enrolled as a student.

## Immunization Policy

- Idaho State Law (Idaho Code 39-1118) requires licensed child care providers to keep immunization records on file for all children ages 4 months to 12 years, including provider’s own children.
- Immunization records must include name of child, date of birth, and the day, month, and year of each immunization the child received.
- Immunization records must be provided before child starts attendance at Messiah’s Children Preschool.
- Children with immunizations missing, incomplete, or not up to date will be excluded from Messiah’s Children Preschool until documentation of current immunizations is provided.
- Parents are responsible for providing current documentation each time the child completes a series.

## EXEMPTIONS

- Immunizations help protect all children and staff from several diseases so exemptions for personal and religious beliefs will not be accepted.
- Medical exemptions signed by a licensed physician stating the child’s life or health would be at risk if any or all the required immunizations were given will be considered after discussion with doctor and parents.

## Snack Policy

- The children will have a snack time every day. The parents are asked to supply snacks for the class. This will occur several times during the school year.
- The snacks need to be commercially prepared and in unopened packages. They need to be nutritious and low in sugar. **At no time will home-made treats be given to the children.** You will be allowed to bring special commercially prepared treats on birthdays and “half- birthdays”.
- Your child’s teacher will have more information.
- Messiah’s Children Preschool will be considerate of food allergies in preschoolers. We will work in cooperation with the parents of the preschoolers to the best of our abilities.

## Clothing and Backpacks

- Carefully label all clothing (jackets, hats, gloves, sweaters, etc.) and other items sent from home.
- ***Please make sure your child is wearing suitable clothing.*** (Messy crafts, weather, playtime)
- We will play outside, weather permitting. Be sure your child is dressed appropriately for the weather. Shoes must be appropriate for running and jumping. (Please no flip flops)
- ***Backpacks or bags are an important item and are necessary from the first to the last day of school.*** Be certain that your child has a way to carry home those important school projects and information. Please make sure the backpack is large enough to hold an 8 ½ x 11 piece of paper.

## Transportation

- The transportation of the child to and from school is the sole responsibility of the parent. Written permission from the parent is necessary for any other person to pick up the child; this includes carpooling.
- Please notify the teacher of any changes in transportation arrangements. Any change is important and must be noted.

## Drop-off and Pick-up

- Drop-off will begin 10 minutes prior to the start of class. We offer two forms of drop-off (pull-up and drop off **or** park and enter.) These will be explained in detail at the parent meeting on the 1<sup>st</sup> day of school. Upon entry, your child will hang up his/her coat and backpack, use the bathroom and then enter the classroom for free-play.
- Pick-up your child promptly at the end of class. At pick-up, sign your child out and check his/her backpack for artwork and important information. Teacher's aides will load everything from your child's cubbie into his/her backpack.
- For safety issues, the exterior doors are locked 10 minutes after class starts until 10 minutes before class is over. If there is a need to come to the classroom between these times, please ring the doorbell or call the preschool at 208-465-4511.
- Your child will be allowed to leave with a parent/guardian or those individuals listed on the Application Form. If an adult arrives to pick up a child, but is not known personally by the teacher, the adult will be asked to provide photo identification—even if the adult is on the authorization list.
- After school care is NOT provided. Parents need to be prompt, as there will be a \$10.00 charge for every 15 minutes a child is left beyond the end of the session. For example, a child left for one hour past the end of class would result in a \$40.00 charge. Any charges imposed under this provision will be payable at the same time or before the next tuition payment, but no later than 30 days after the charges were accrued. Failure to pay fees will be dealt in the same manner described in the "Delinquent Tuition Policy" section.

## Discipline Policy

- Discipline is based on an understanding of the child's needs and stages of development. Discipline and guidance are designed to help the child develop self-control, acceptable behavior, and respect for the rights of others. Discipline is fair, reasonable, consistent, and related to the child's behavior.
- There will be no corporal punishment. Redirection, speaking with the child, and "time out" periods will be used. You will be notified of any disciplinary problems.
- A child may be asked not to return to the group when one or more of the following conditions are continually observed:
  1. A child's conduct hurts or endangers another child/children.
  2. There is wanton destruction of property.
  3. A child's behavior is unruly, disruptive, prevents other children from participating in the class activities, or causes an undesirable atmosphere in the room.
  4. A child requires more of the teacher or teacher's aide time than our teacher/child ratio allows.

## Tuition Payment Policy

- Students enrolled at Messiah's Children Preschool will be charged a tuition amount established annually by the Preschool. Tuition for the Three- and Four-Year Old program is based on a yearly tuition rate. We offer families the choice of monthly payments or one annual payment.
- For families choosing the annual payment option, we offer an Early Bird discount of 5% if enrolled before June 1st and the payment is received prior to September 1st. A discount is also offered for families enrolling two or more children. The first (eldest) child is charged full tuition and each additional child will receive a 10% discount off the annual/monthly tuition.
- A student shall remain in enrollment with current tuition payments. Tuition for late enrollees will be prorated for the month.
- For families choosing the monthly tuition payment option, payment for **the first and last month's tuition must be paid on or before September 1st**. Payment for the last month's tuition will be held as a credit throughout the school year and applied on May 1st. In the event that a parent withdraws a child from school prior to May, the last month's tuition will be applied to the last month of the child's attendance. Thirty (30) day written notice is needed to apply the tuition for the last month of enrollment. If thirty (30) day written notice is not given, the tuition cannot be refunded. For students enrolling after September 1st, the last month's tuition will be due within thirty (30) days of attendance.
- If a child is asked to withdraw from school for behavioral problems, prorated tuition for that month will be refunded. In the event a parent withdraws a child from school, there will not be a tuition refund for that month. If full year's tuition is paid, a refund will be issued for the following month through May.
- Tuition payment envelopes are available. Envelopes may be mailed to the preschool or placed in the preschool lock box located near the office.

### **CASH PAYMENTS WILL NOT BE ACCEPTED!**

Checks or money orders should be made payable to Messiah's Children Preschool. There is a \$20.00 return check fee. We are licensed with the state of Idaho, however, we are NOT certified to accept ICCP payments. In case of extended absences, tuition must be kept current in order to keep the student's name on the roster.

## Tuition Delinquency Policy

Messiah's Children Preschool will adhere to the following steps in dealing with delinquent tuition payments:

1. Monthly tuition payment is due on the 1st of each month, if payment is not made by the 10th of the month, a letter will be given reminding the parents the tuition is past due.
2. If after the 20th of the month and no payment is received, the parents will be contacted regarding the late tuition payment and a \$10 late fee will be assessed.
3. If at the end of the month no payment is received, a written letter from the Preschool will be mailed to the parents advising them the tuition is overdue. If the payment is not received within seven (7) days, the Preschool will no longer accept the student, and the last month's tuition will be applied to close the account with a zero balance.

Messiah's Children Preschool does not wish to turn away a student due to tuition issues. Parents can avoid the above steps by making their needs known to the Preschool.

## Fee Schedule for the school year of 2022-2023

### Three year old class

Application fee	\$25.00 (non-refundable)
Annual Tuition	\$1,125.00
Monthly Tuition	\$125.00 (Sept.—May)
Early Bird*	\$1,068.75

### Four year old class

Application fee	\$25.00 (non-refundable)
Annual Tuition	\$1,350.00
Monthly Tuition	\$150.00 (Sept.—May)
Early Bird*	\$1,282.50

\*Early Bird discount- Must be enrolled **BEFORE** June 1<sup>st</sup> and paid **BEFORE** Sept 1<sup>st</sup>.